

Anschluss von Einzelbatterieleuchten Connection of Self-contained luminaires

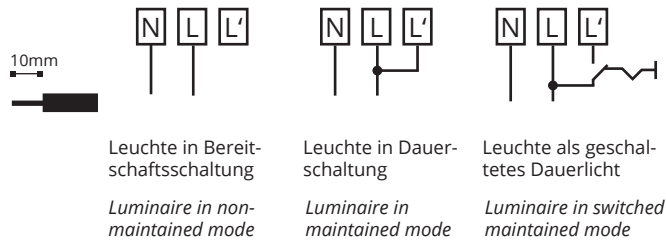

Anschluss von Zentralbatterieleuchten Connection of central battery luminaires



Hinweise zur Konfiguration der Leuchtenelektronik entnehmen Sie bitte der separat beigefügten „Setup“-Anleitung.

Information on the configuration of the luminaire electronics can be found in the separate „Setup“ manual.

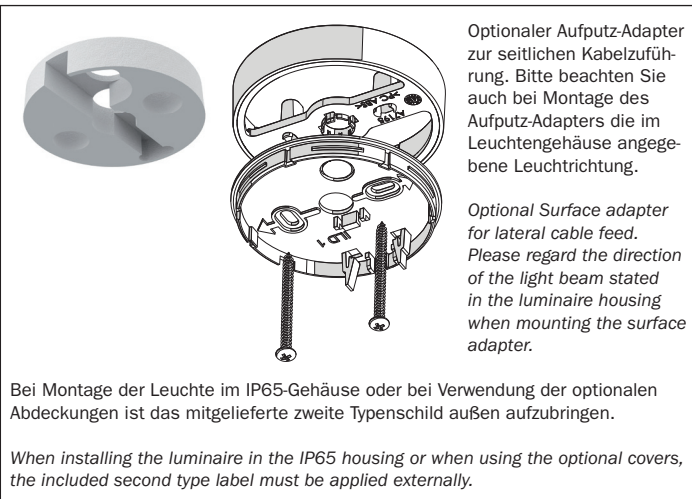

Wichtig: Bitte achten Sie darauf, den Akku nach Vorschrift zu wechseln, da ansonsten keine Funktion gewährleistet ist.



Bei Batteriewechsel alten Akku nicht im Hausmüll entsorgen!

Important:

Make sure the battery is replaced as stated in regulations, otherwise the function of the lamp is not guaranteed.

When replacing battery don't throw old accu into domestic waste!

ANL-DE-EN-ILxL • 11/2022

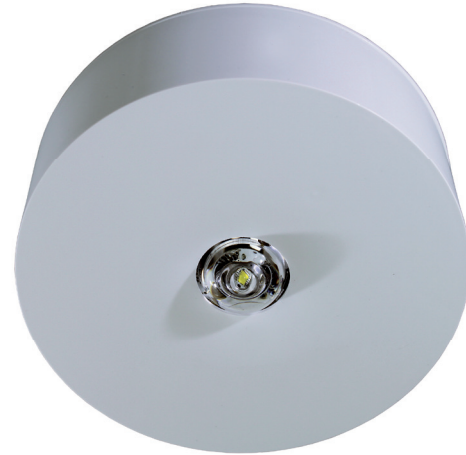

Montage / Mounting



Einbaumontage / Recessed mounted

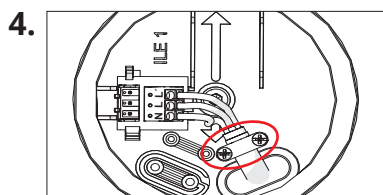
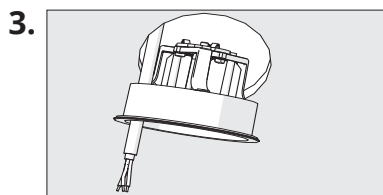
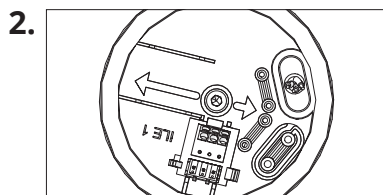
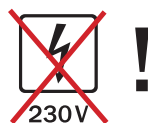
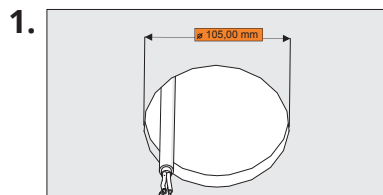

Montieren Sie mind. eine der beiden Zugentlastungen und führen den elektrischen Anschluss hindurch.

Install at least one of the two strain reliefs and pull the electrical connection through.

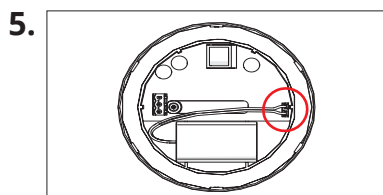

Akku anschließen (nur bei Einzelbatterieleuchten). Deckel auf das montierte Leuchtengehäuse drücken.

Connect battery (for self-contained luminaires). Press the complete cover containing the electronics to the mounted luminaire body.

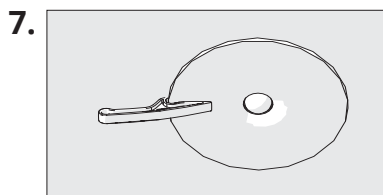
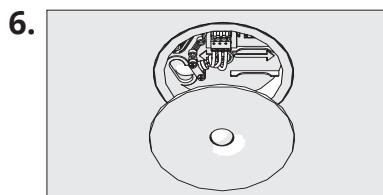

Zum einfachen Öffnen der Leuchte ist ein optionaler Öffner erhältlich.

For easy opening of the luminaire an optional opener is available.

Aufbaumontage / Surface mounted

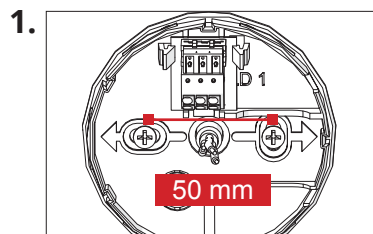

Während der Montage darf keine Spannung anliegen.

Mains supply must be suspended during installation

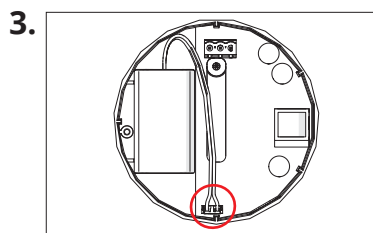
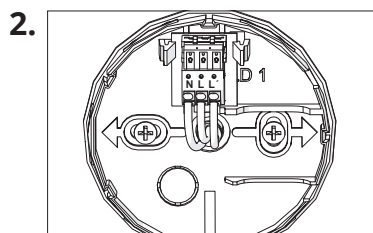

Akku anschließen (nur bei Einzelbatterieleuchten). Deckel auf das montierte Leuchtenunterteil drücken.

Connect battery (for self-contained luminaires). Press the complete cover containing the electronics to the mounted luminaire body.

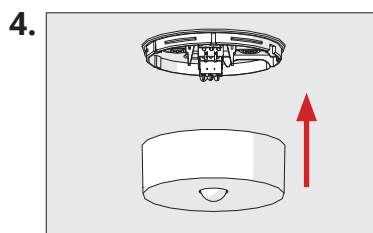

Linse einsetzen / Insert lens

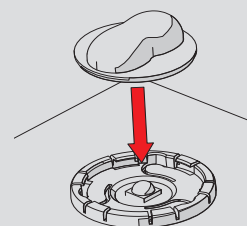

snap into holder

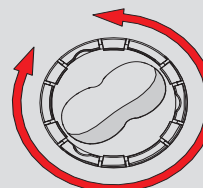

rotate to adjust

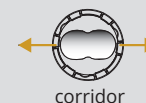

corridor

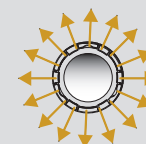

open area